

## Reporting on Twitter

1. Click on the little v in the top right corner and choose "Report Tweet"

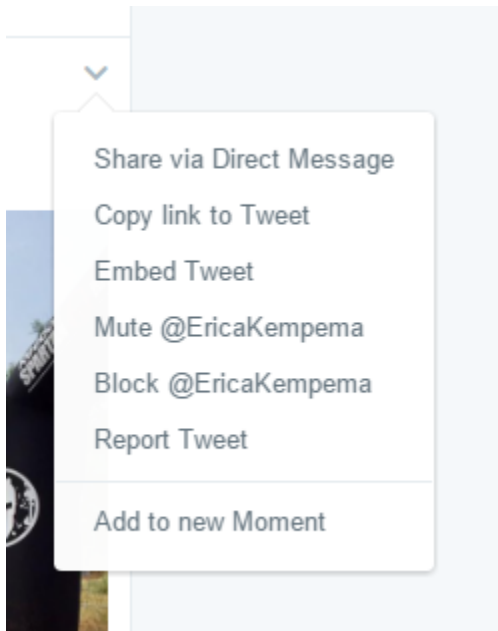

2. Select the option "It's abusive or harmful" on the first Report screen

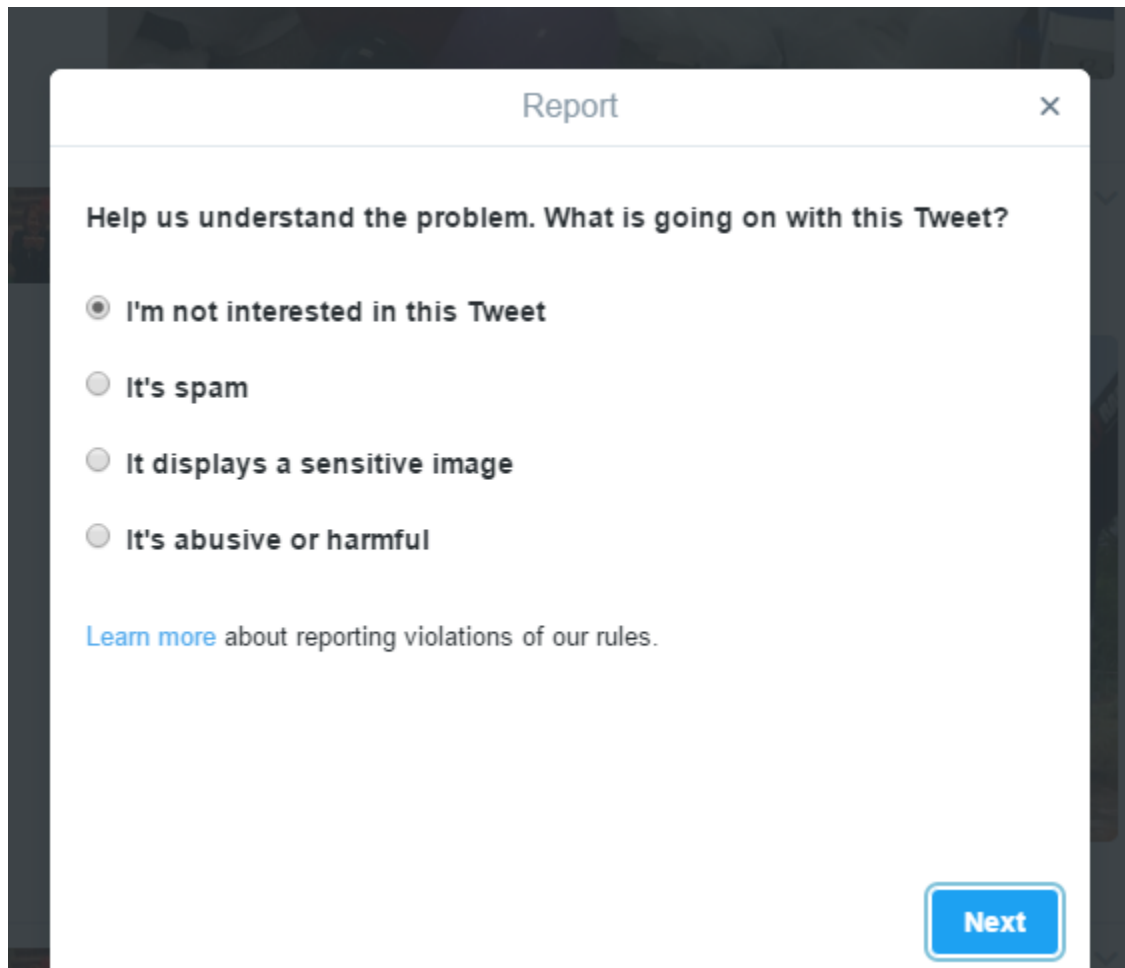

3. On the next Report screen select "This person might be contemplating suicide or self-harm"

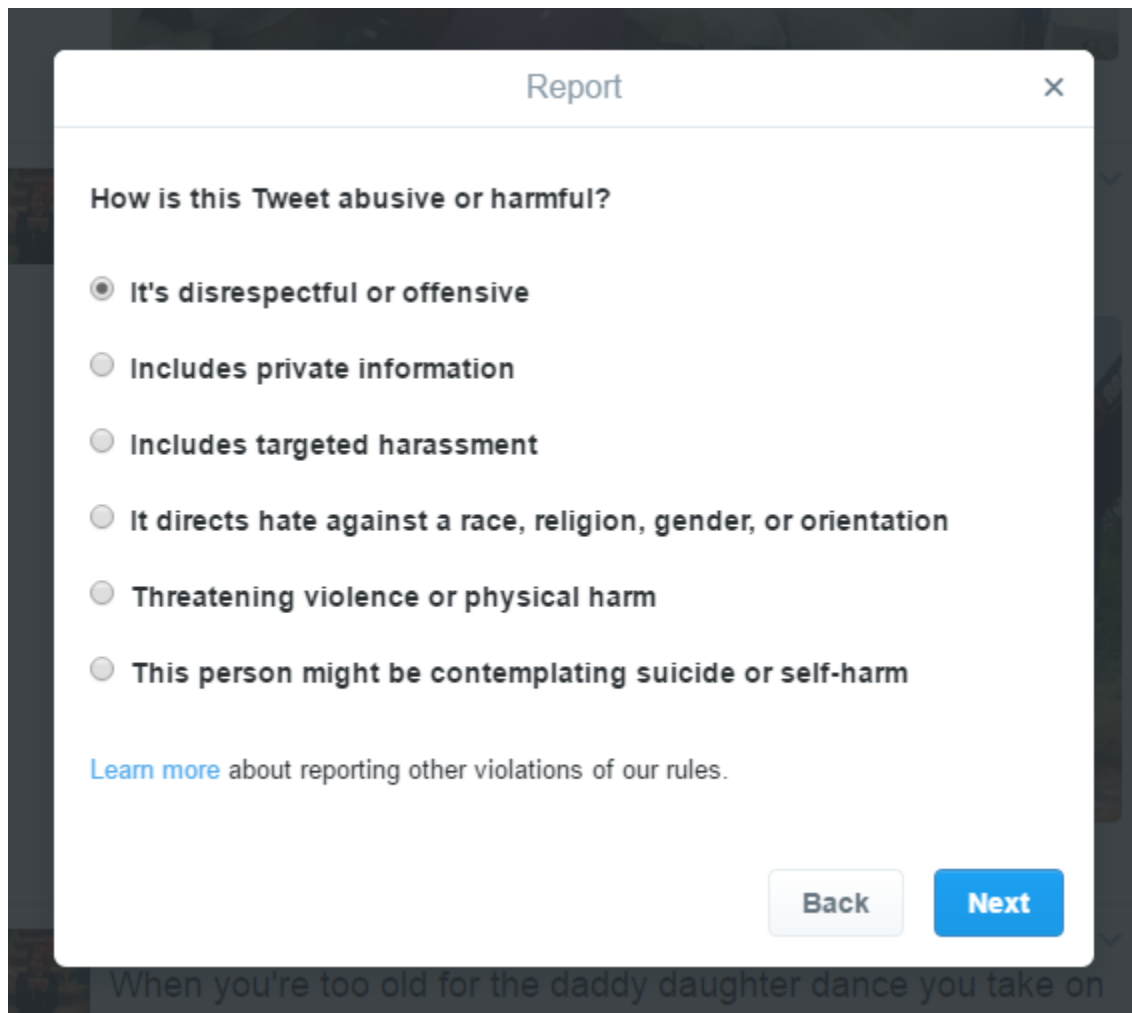

4. If the tweet is referencing themselves choose "@{insert name}" or select "Someone else" if the Tweet is not talking about themselves.

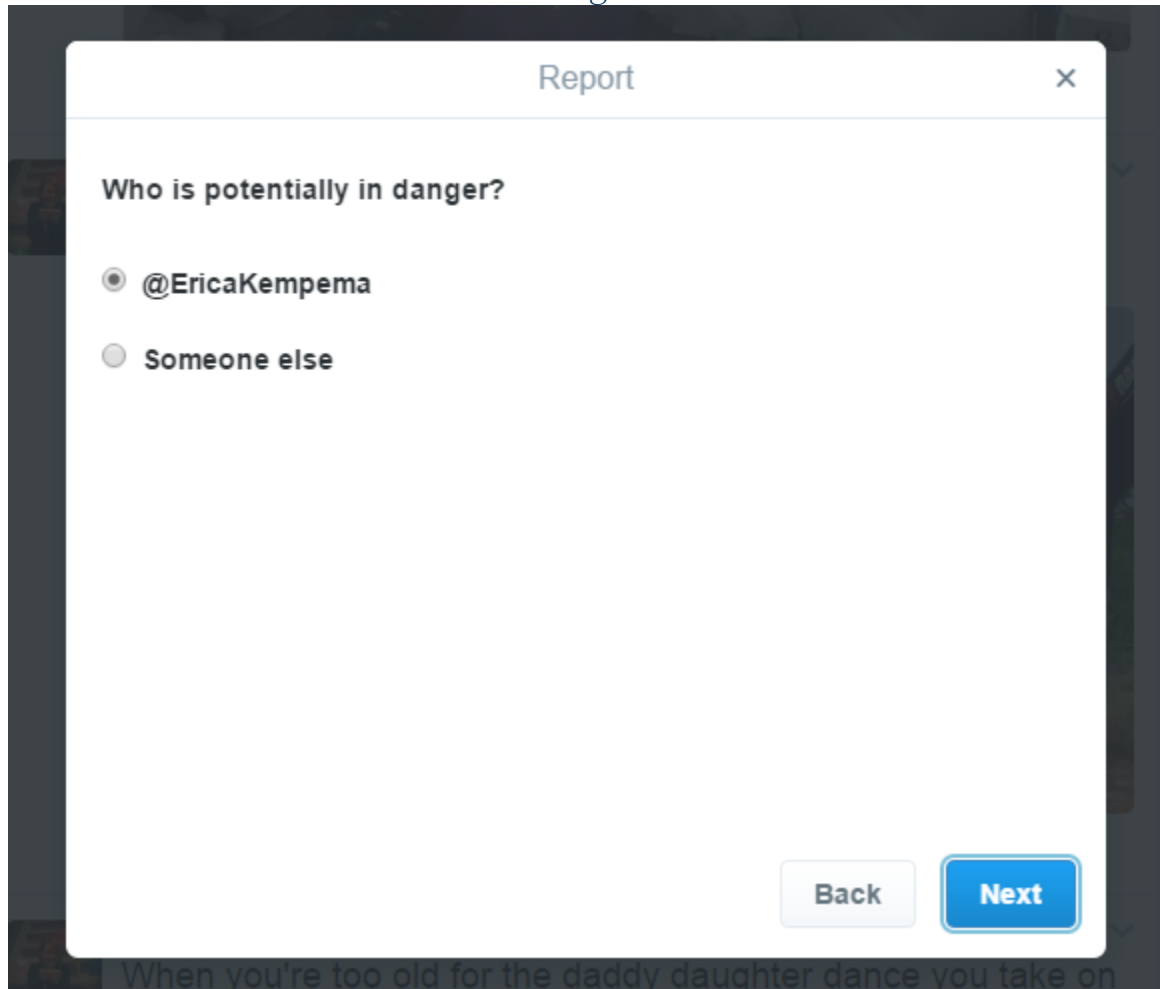

The screenshot shows a white dialog box titled "Report" with a close button (X) in the top right corner. Below the title is the question "Who is potentially in danger?". There are two radio button options: "@EricaKempema" (which is selected) and "Someone else". At the bottom right, there are two buttons: "Back" (disabled) and "Next" (active).

5. You will get a screen that thanks you and confirms that your identity will be kept confidential. Please feel free to provide more details if possible.

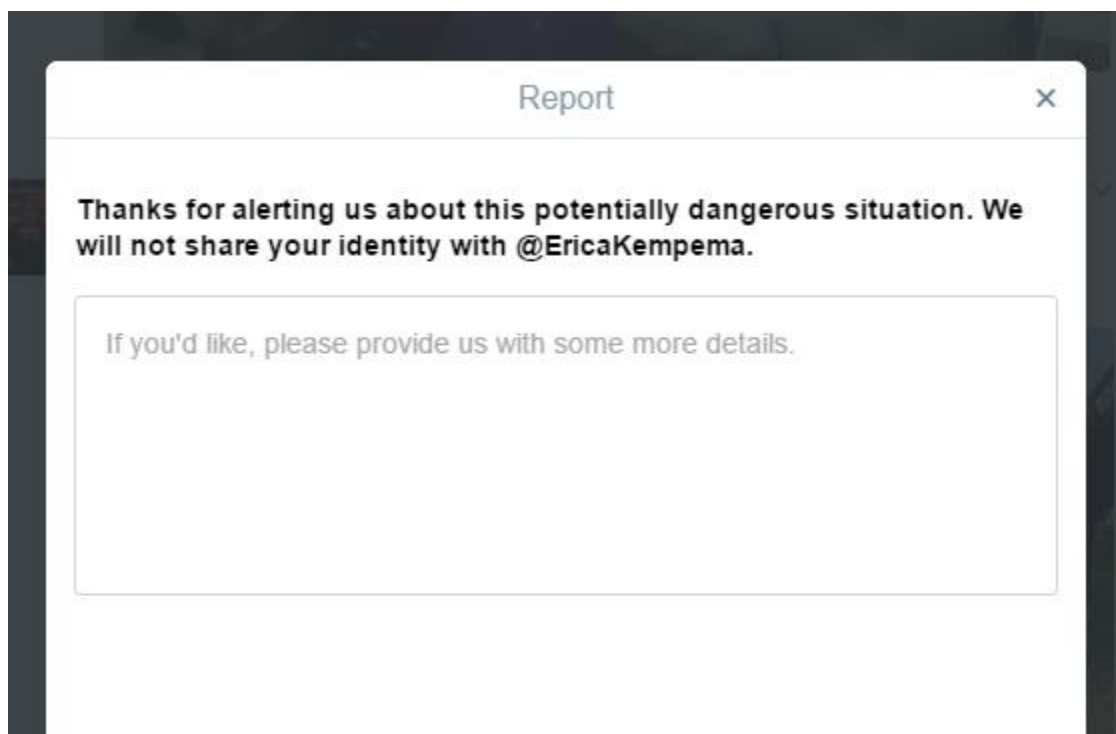

The screenshot shows a white dialog box titled "Report" with a close button (X) in the top right corner. Below the title is a thank you message: "Thanks for alerting us about this potentially dangerous situation. We will not share your identity with @EricaKempema." Below the message is a text input field with the placeholder text "If you'd like, please provide us with some more details."